

...tectural designs, building materials, supplies, food, trade, best of all, people and their... moved along the canal at... are rapid pace than ever... e. Now, drawing on the... creative energies and... er spirit that built the canal... n, community members and... c-minded citizens from... s the state have committed... selves to this new effort.

We think that this new... ty will benefit individuals, organizations and businesses... hout the region. We trust... ou will feel so too, as you... ore about the Wabash & Erie Canal Conference and... nterpretive Center. We now have... pportunity to **Open the Gates**... iscover the lessons learned... a colorful canal heritage.

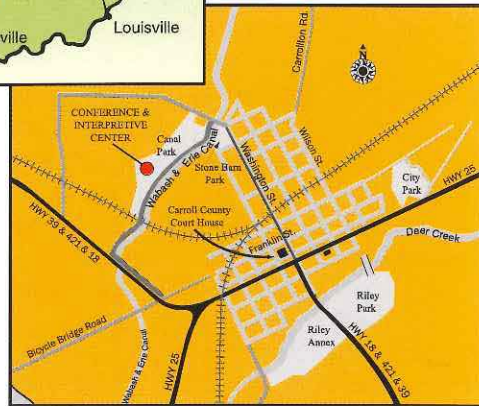

The Wabash & Erie Canal once stretched 468 miles and connected Toledo, Ohio on Lake Erie with Evansville, Indiana on the Ohio River.



City of Delphi

WABASH & ERIE
CANAL



INTERPRETIVE
CENTER

CELEBRATING THE PAST
• BUILDING FOR THE FUTURE •

The Carroll County Wabash & Erie Canal, Inc.
1030 N. Washington St., Delphi, IN 46923
765•564•6572

Web Site: www.carlnet.org/canal

Design & Illustration • Lacy Design • Printing & Graphics • O Graphics, Inc.

12/00 VF 605 HH
Ind. Carroll Co. Canals

Wabash & Erie Canal Conference & Interpretive Center

Coming in 2002 to Canal Park
Delphi, Indiana

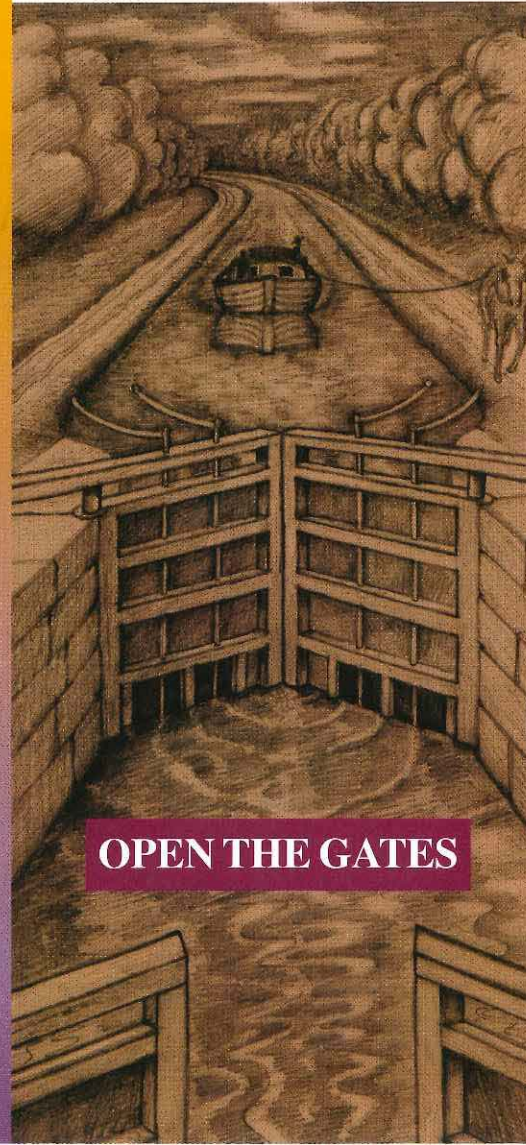

Introducing the *Wabash & Erie Canal Conference and Interpretive Center* -- a new facility with a historical perspective designed to connect us with the rich heritage ushered in by Indiana's early canal system.

The Carroll County Wabash & Erie Canal, Inc., a not-for-profit organization, has joined forces with the City of Delphi to construct a 12,000 square foot building alongside the old canal and towpath in Canal Park. When completed, this structure will house both an interactive exhibit gallery and a conference center with seating for over 275 guests.

Considered an engineering wonder, the canal opened Indiana to immigration and created an economic and cultural connection to New York and New Orleans.

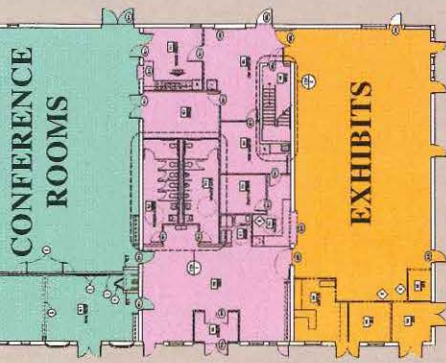

First Floor Plan

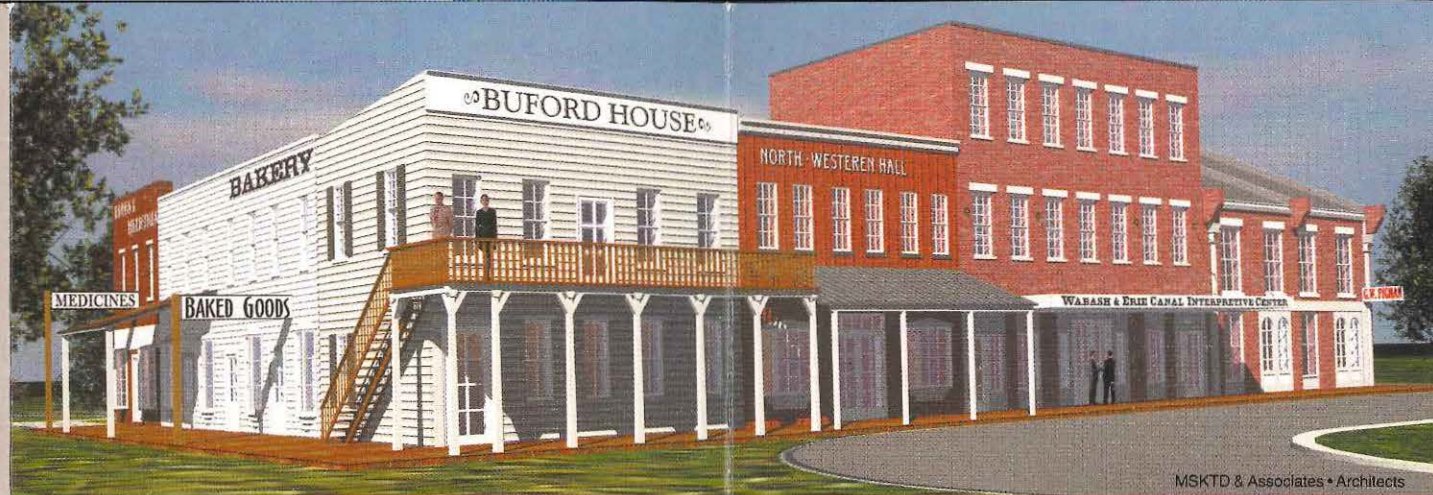

MSKTD & Associates • Architects

PROPOSED CANAL CONFERENCE & INTERPRETIVE CENTER

THE NEW FACILITY will be located just a few blocks from the Carroll County Courthouse, nestled in the natural beauty of the Wabash River valley. Visitors will find themselves drawn into the mystique of Indiana's canal era as they enter Canal Park down a quiet shady lane. They will see the canal and its towpath as they pass several historic structures situated in the park. Perhaps a heron will come into view as it takes flight. The spell will not be broken by the appearance of the Center, for its exterior design is based on Delphi's old commercial buildings, as documented in historic photographs.

The warm and welcoming entry will lead to a simple but elegant lobby. Nearby will be a reception desk, gift shop, and other visitor amenities. All of this introduces the visitor to the major components of the facility - the exhibit gallery and the conference facilities.

EXHIBITS highlighting the history of the Wabash & Erie Canal will occupy approximately 3,100 square feet. Too often today the story of this exciting and important waterway is overlooked. The new Interpretive Center will use interactive exhibits to tell us this fascinating story in an entertaining way. Other exhibits will walk us through the history of the canal, from the Irish workers who built it to the people who traveled its waters. Canal boats and draft mules, businessmen and boat captains, good times and bad times, all will be remembered here.

CONFERENCE facilities will be available in the opposite side of the building, with bay windows overlooking the canal. Designed for receptions, lectures, plays, and business meetings, the conference area will accommodate over 275 guests. Moveable walls will provide the flexibility needed to subdivide the room for "breakout sessions" and concurrent presentations. Between sessions, guests will find respite in the adjacent trail system stretching along the banks of the canal and the nearby Wabash River.

ECONOMIC GROWTH and opportunity are among the promises of this new Center. Canal enthusiasts already come to Delphi to visit the longest remaining watered section of the Wabash & Erie Canal. Other visitors come to enjoy the trail system, view the historic bridges and ponder the archaeological sites. This new facility will expand our appeal and attract a broader segment of the tourist market. Along with the planned Prophetstown State Park, Indiana Beach, Purdue University, Tippecanoe Battleground, and other nearby attractions, the Center will provide another reason for people to visit this region. Just as the canal spurred the local economy in the 1850s, the new Wabash & Erie Canal Conference and Interpretive Center will help stimulate our economy in the 21st century.



LifeSpace Design

Interactive exhibits invite hands-on activity from children and adults alike.

YOU HOLD THE KEY to this exciting new development. All of Indiana will benefit from this unique facility. Funding for building construction is being provided in part by grants from the Indiana Department of Transportation (INDOT), the Department of Natural Resources (DNR) and the Community Foundation of Carroll County. The exhibits are being paid for in part by a separate grant from the Wabash River Heritage Corridor Commission. The state is doing its share! We need your help to complete the exhibits and ensure that this center will be available for future generations.

Donations from individuals, foundations and corporations are necessary to support completion of the museum exhibits. Funds are also needed for office equipment, tables and chairs, and various other furnishings.

The City of Delphi and Carroll County Wabash & Erie Canal Incorporated (CCWECI) have teamed up to make this facility available to young and old alike. As a 501(c)3 nonprofit organization, CCWECI will accept your tax-deductible gift as allowed by law. Gifts may be in the form of cash, stocks and securities, real estate, or other personal property that has cash value. CCWECI will be happy to help you establish a planned giving program which suits your future needs.

